



DIRECCION:
AUTOPISTA
MEXICO-QUERETARO
KM 175+494 COLONIA
EL SAUZ BAJO

TEL: 01 427 272 40 41

EQUIPMENT DESCRIPTION:

LOAD ELEVATOR

LOAD 500KG

COURSE: 2.30M

STATIONS: 2

HYDRAULIC UNIT: 2HP

SELLER: ING. MAURICIO COMPAGNY B.

BUSINESS NAME:SERVICIOS DE INGENIERIA
DESARROLLO DE PROYECTOS Y
MANTENIMIENTO GENERAL S.A. DE C.V.
NO. FROM CUSTOMER: 27081-19028

DATE: 08/030/2022

CUSTOMER CONFORMITY SIGNATURE:

EQUIPMENT SHIPPING CONDITIONS

CABIN:

COLUMNS:

SPAN DIMENSIONS:

ELEVATOR COLOR

TEAM:TRAFFIC YELLOWV

FINISHES: EXPANDED METAL

ENERGIZATION

SINGLE PHASE 110 VAC

PIPE -

ACCESSORIES

SUPERIMPOSED KEYBOARD

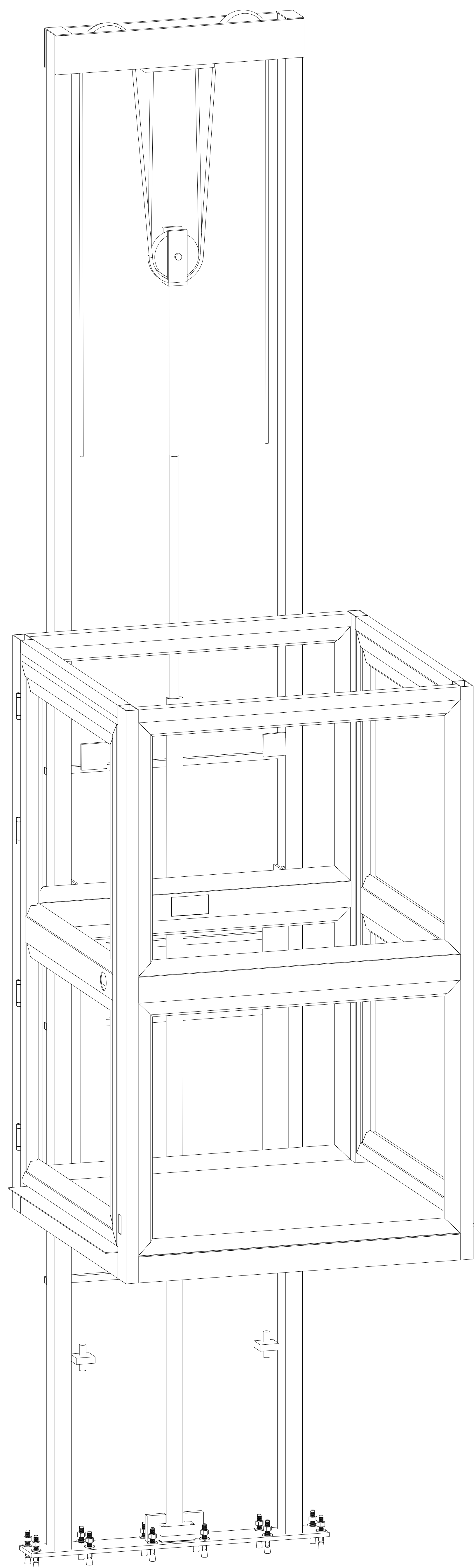

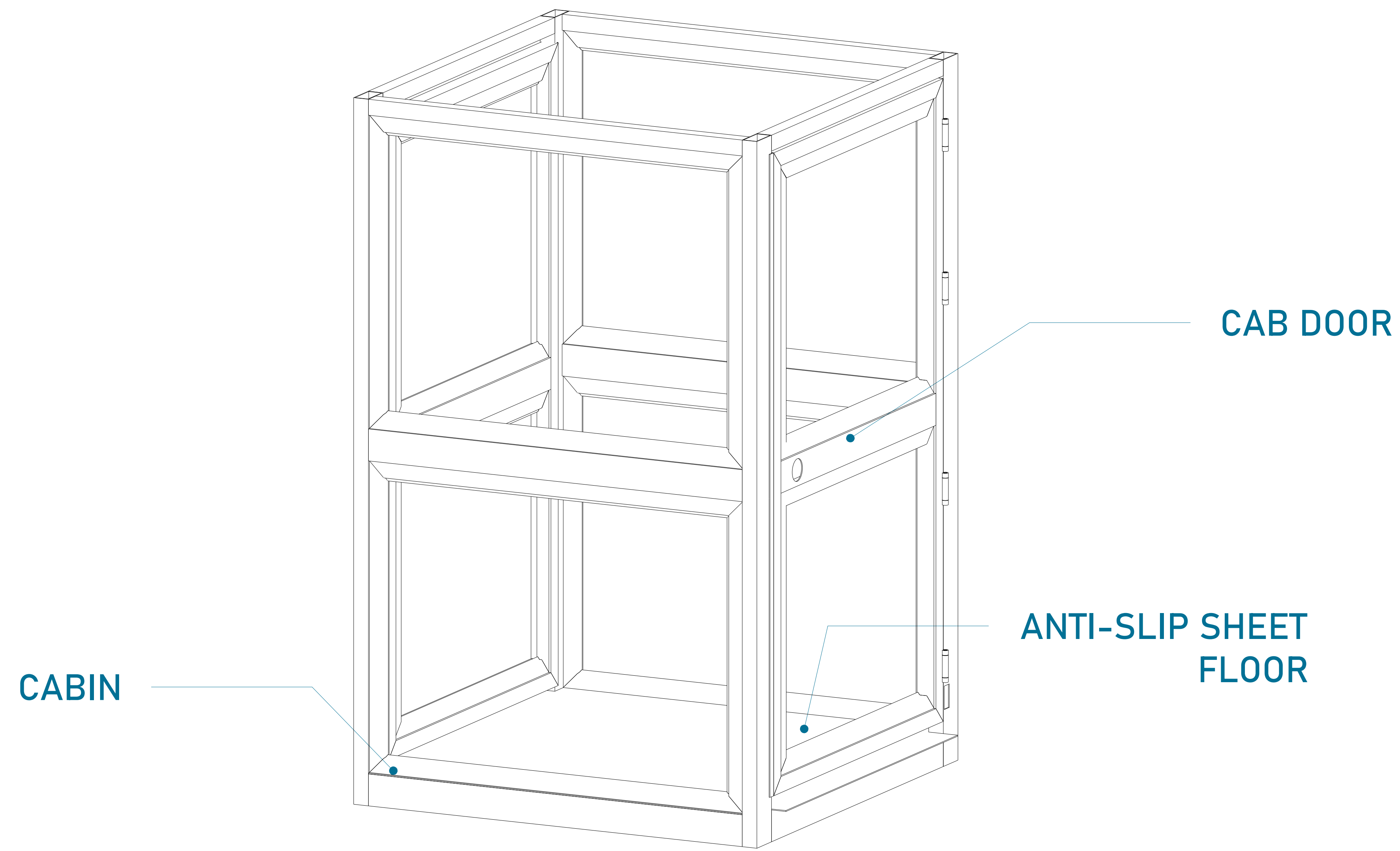

CABIN (ISOMETRIC VIEW)

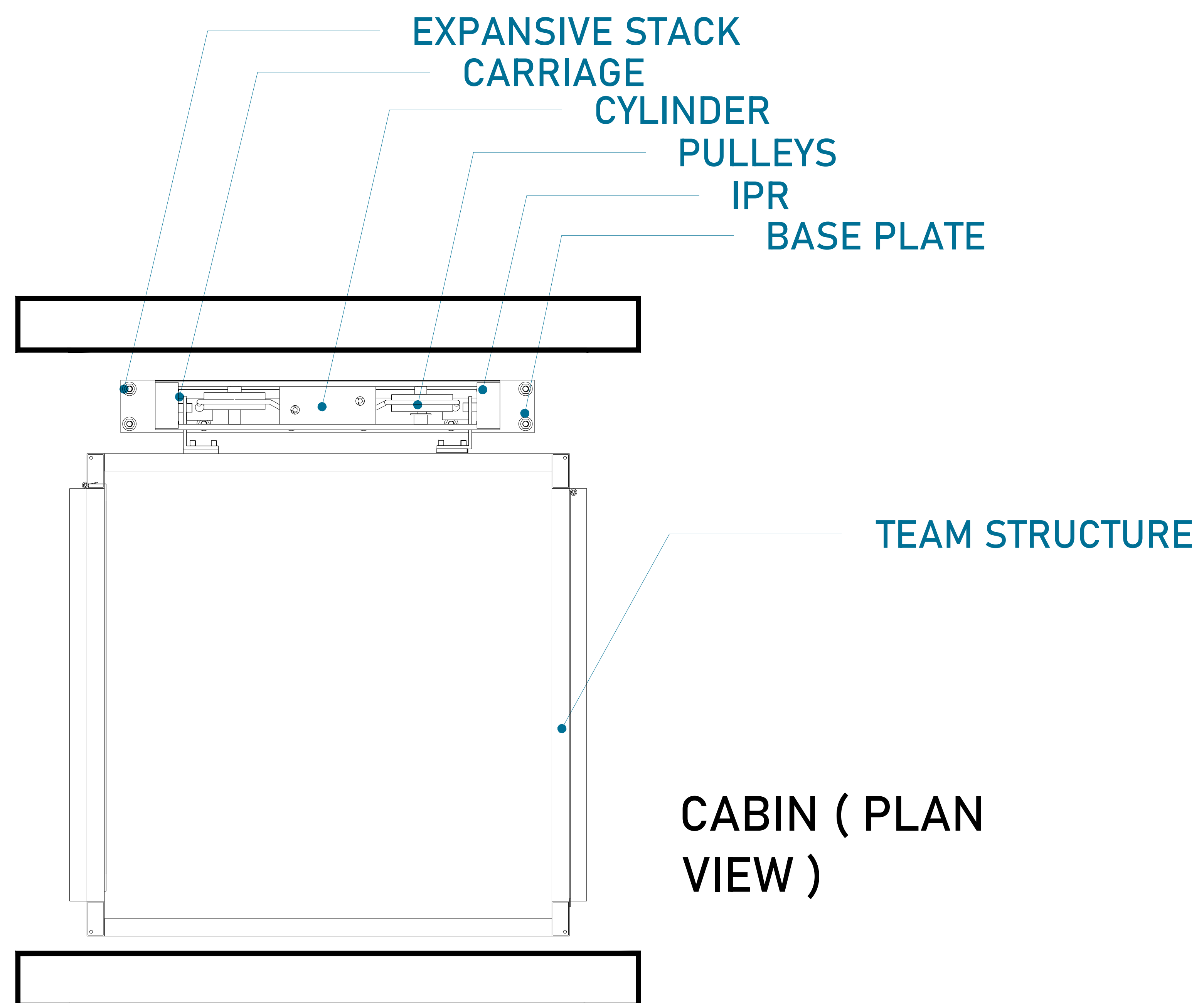

CABIN (PLAN VIEW)

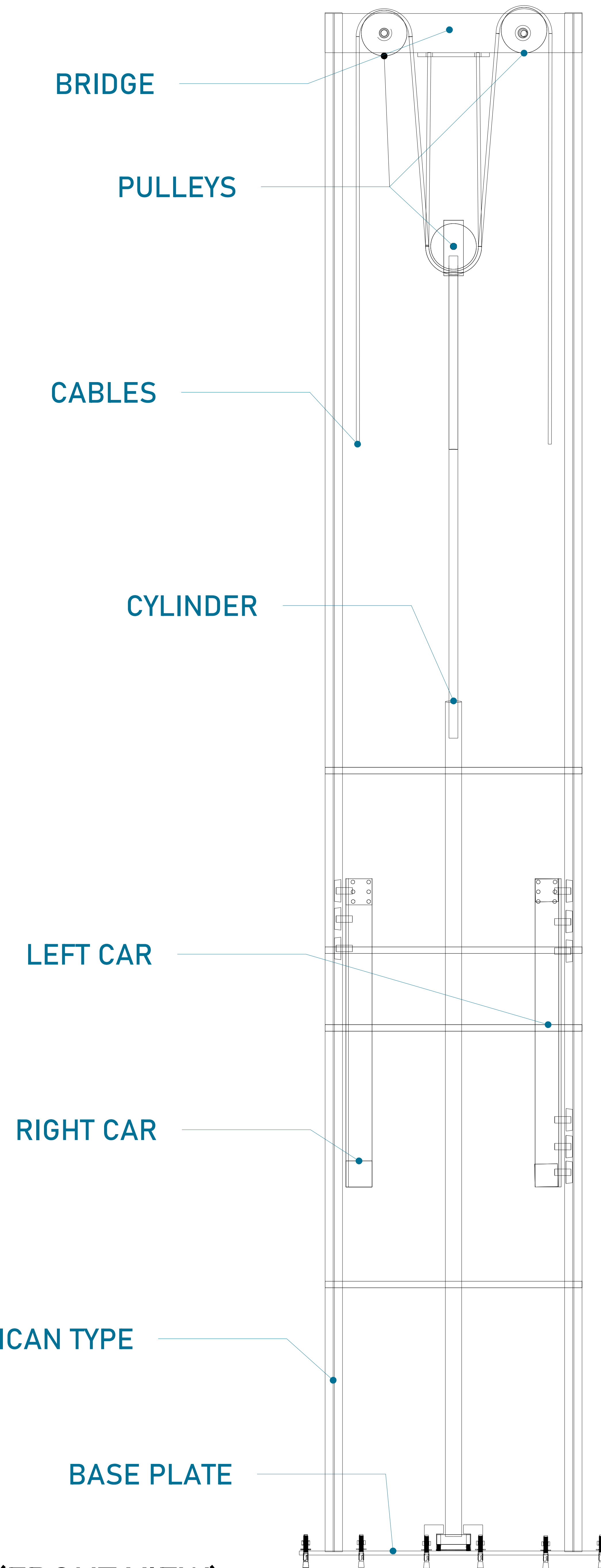

MECHANISM (FRONT VIEW)

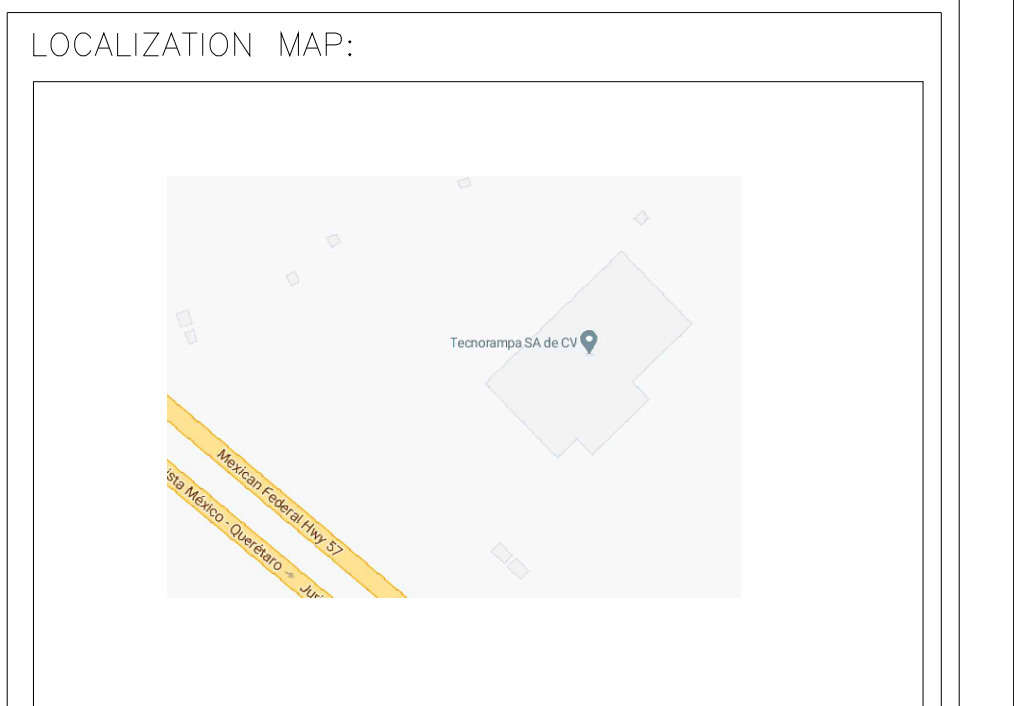

LOCATION
Mexico-Querétaro Federal Highway

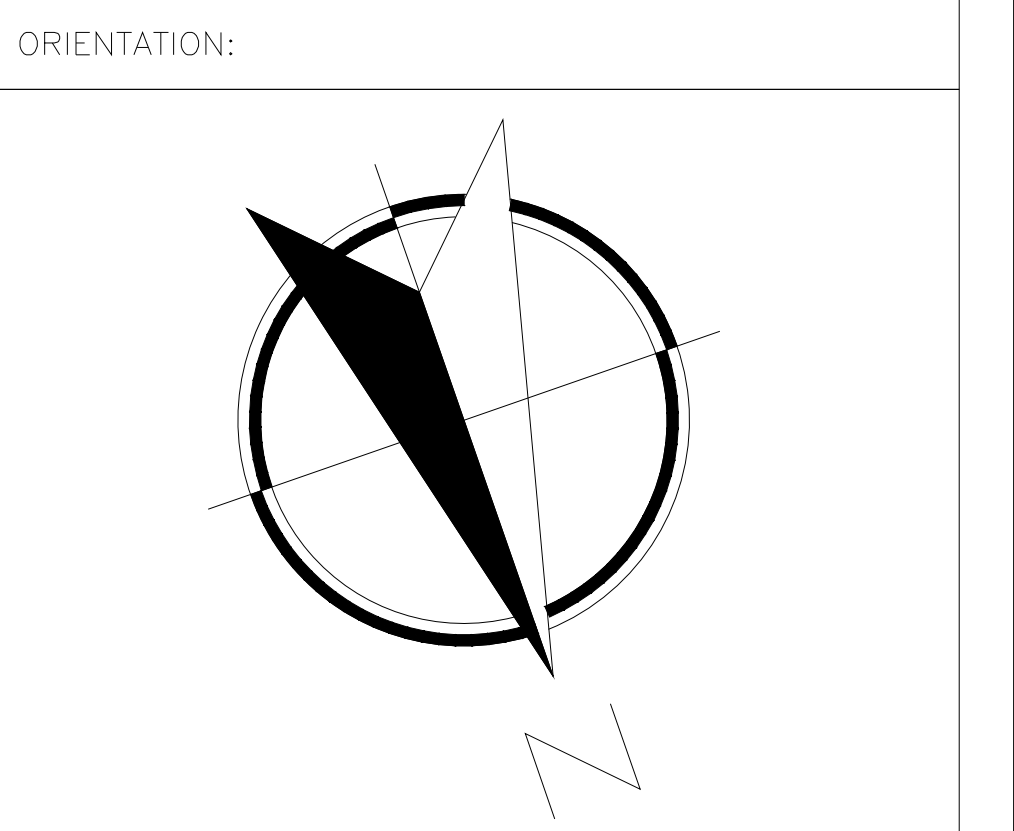

GENERAL NOTES

MODIFICATIONS TABLE:

NO.	DESCRIPTION	DATE

BUSINESS: **TecnoRampa**
SOLUCIONES DE TRANSPORTE Y SERVICIOS

BUSINESS NAME: **CUSTOMER NAME**

VOBO: _____ SELLER: _____
DATE: _____ ELEVATOR: _____

FLAT: _____ KEY CODE: **A-1**
DESCRIPTION OF PARTS

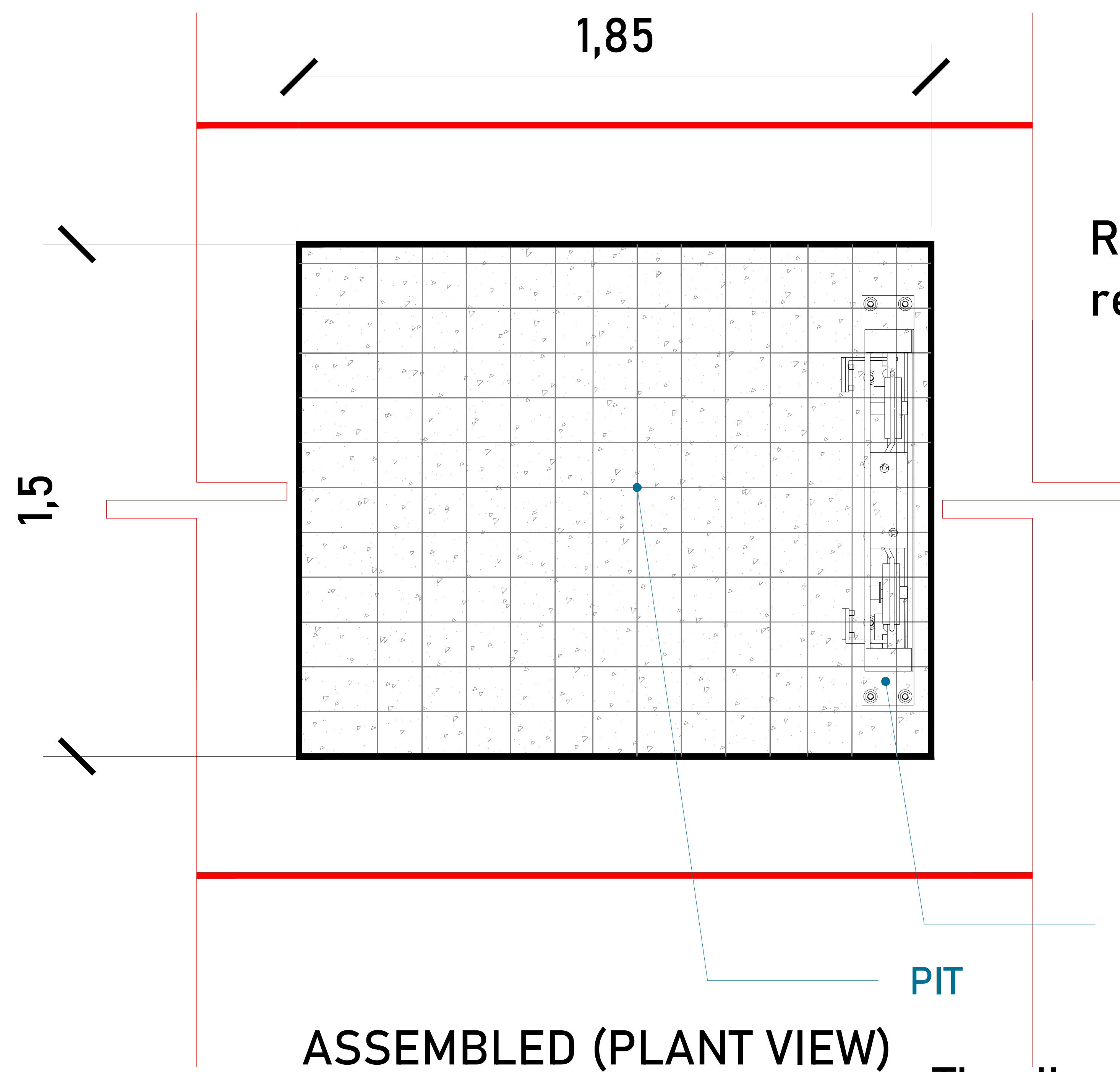

Reinforced concrete pavement with a resistance of $F'C = 250 \text{ kg/cm}^2$.

COLUMN HEIGHT	
Pit	0.20m
Route	2.30m
Overshoot	1.80m
Total	4.30m

ASSEMBLED (PLANT VIEW)

The dimensions of the area for the elevator in this case of 1.50m x 1.85m must be the same in all the stations that the site has.

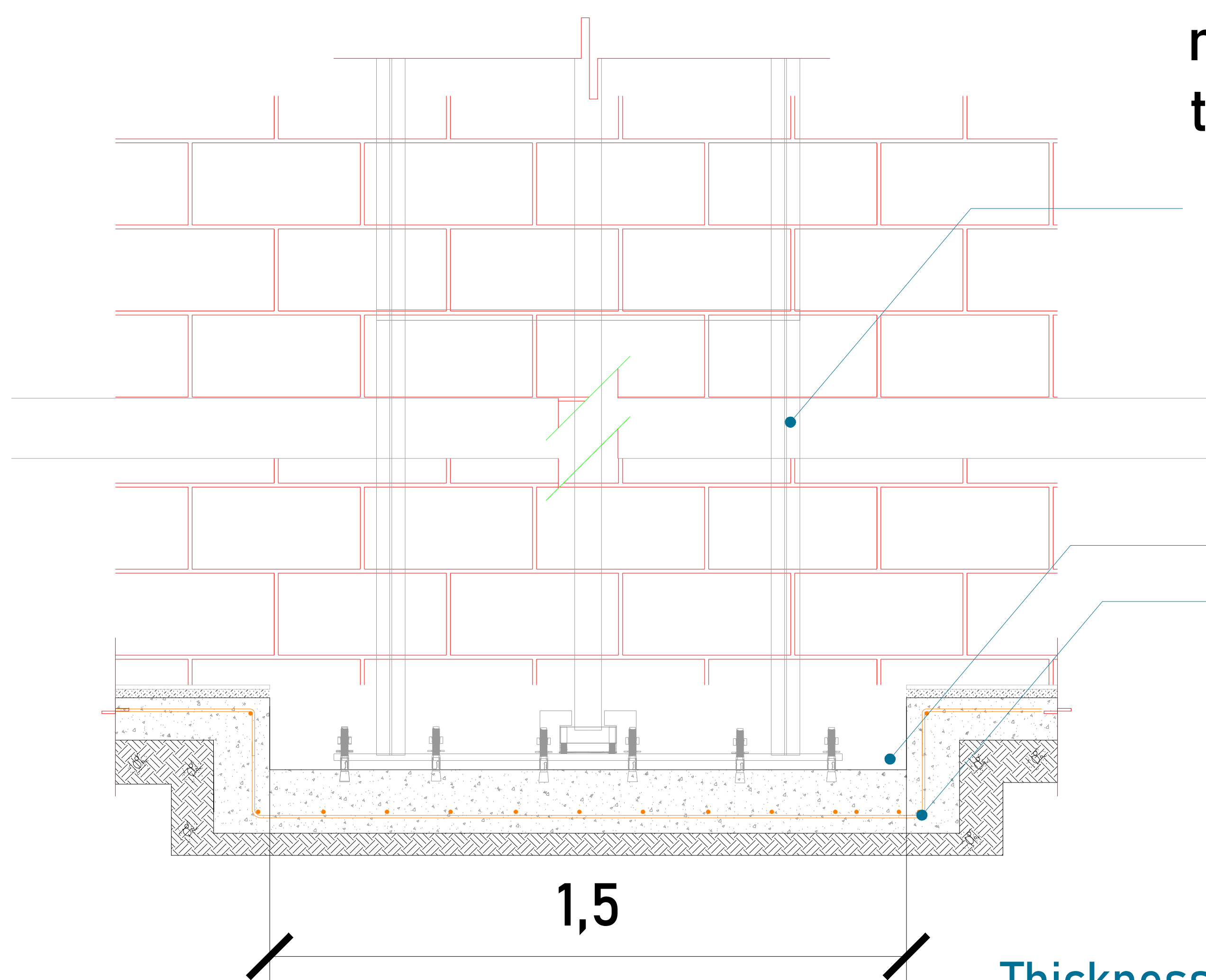

PIT (FRONT VIEW)

Thickness of reinforced concrete pavement.
Resistance of $F'C = 250 \text{ kg/cm}^2$

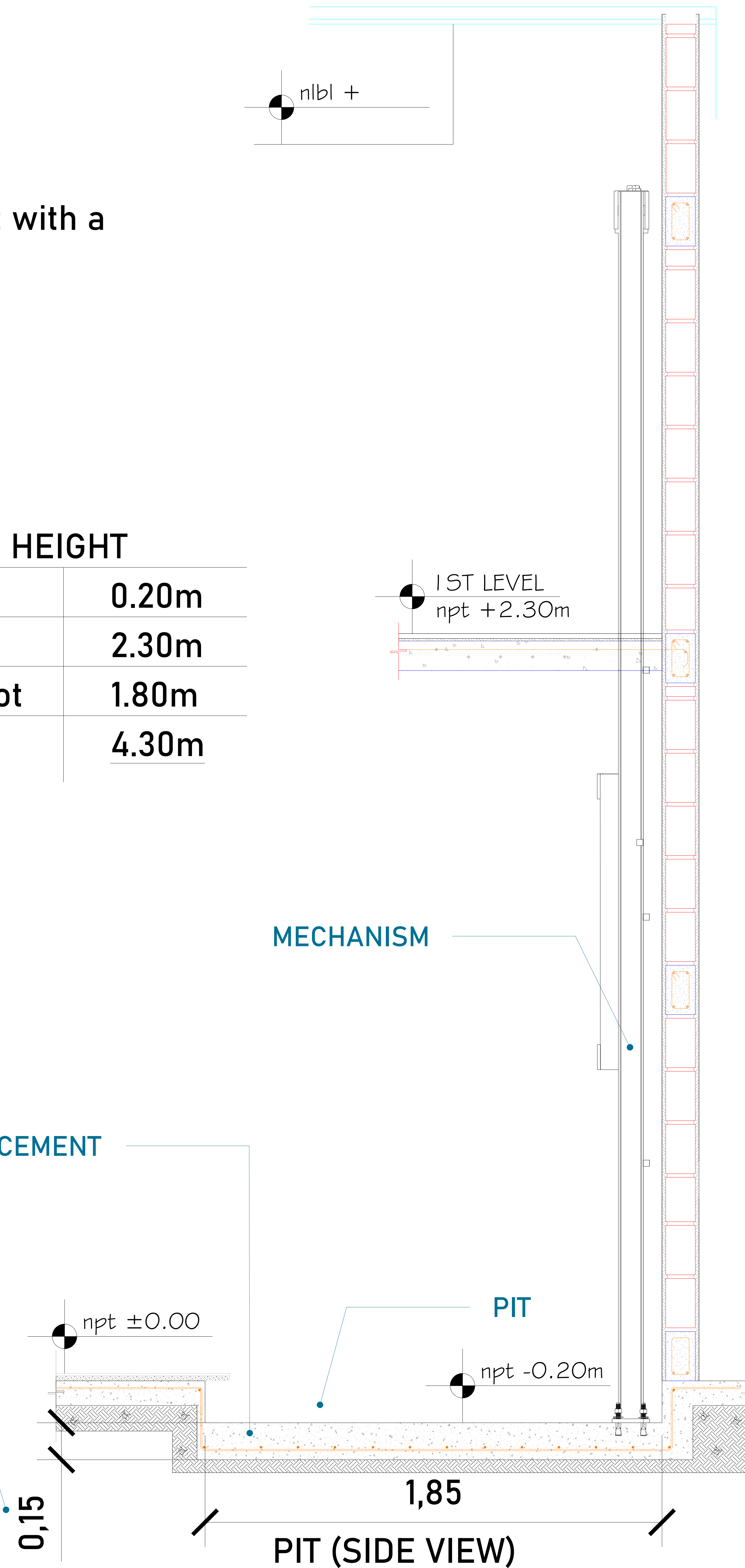

PIT (SIDE VIEW)

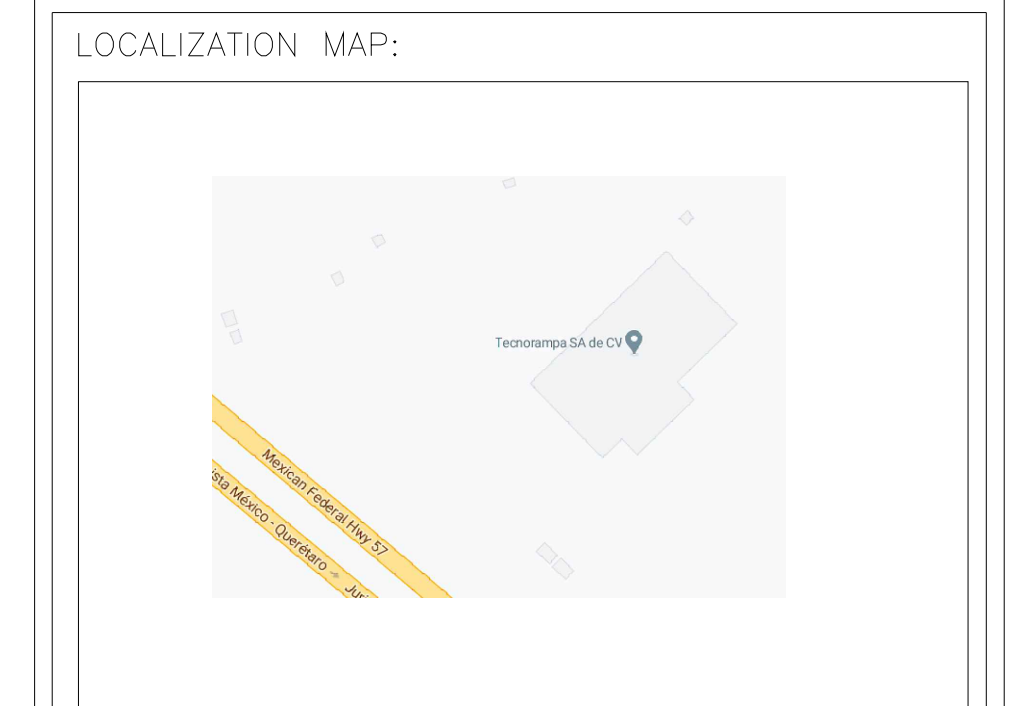

LOCATION
Mexico-Querétaro Federal Highway

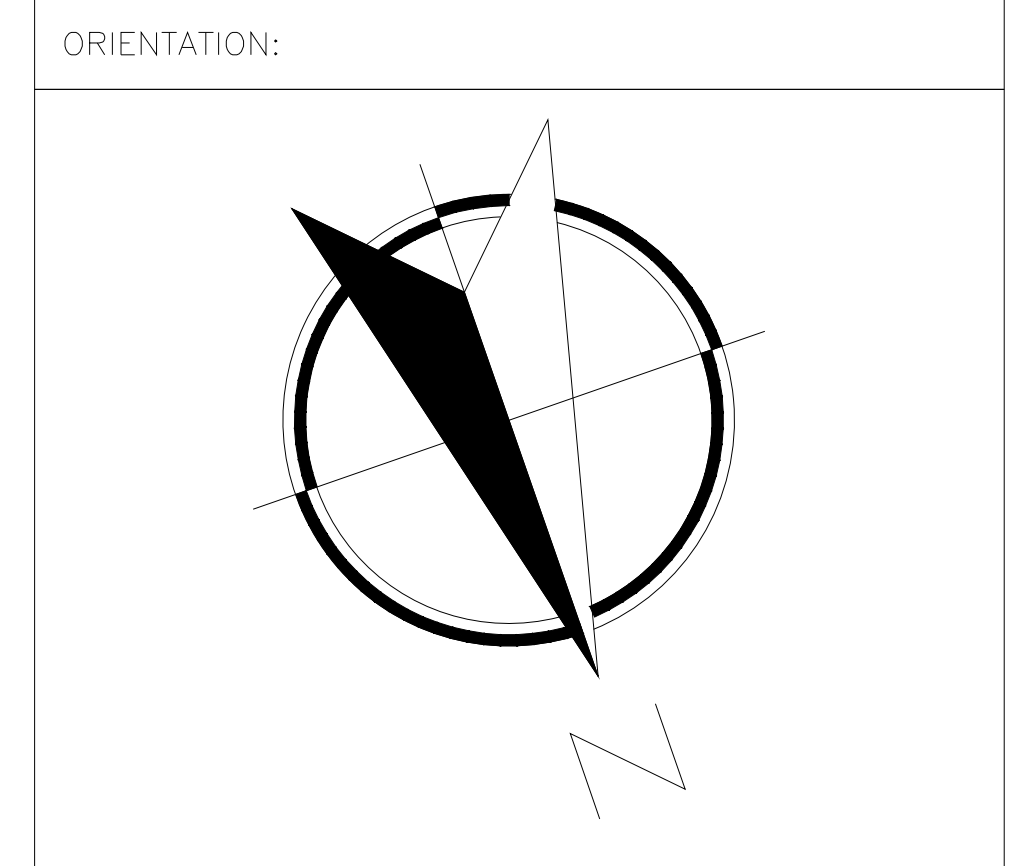

MODIFICATIONS TABLE:

NO.	DESCRIPTION	DATE

BUSINESS: **TecnoRampa**
SOLUCIONES DE INGENIERIA Y SERVICIOS

BUSINESS NAME: **CUSTOMER NAME**

VOBO: _____ SELLER: _____
DATE: _____ ELEVATOR: _____

FLAT: **HOLE FOR ELEVATOR** KEY CODE: **A-2**

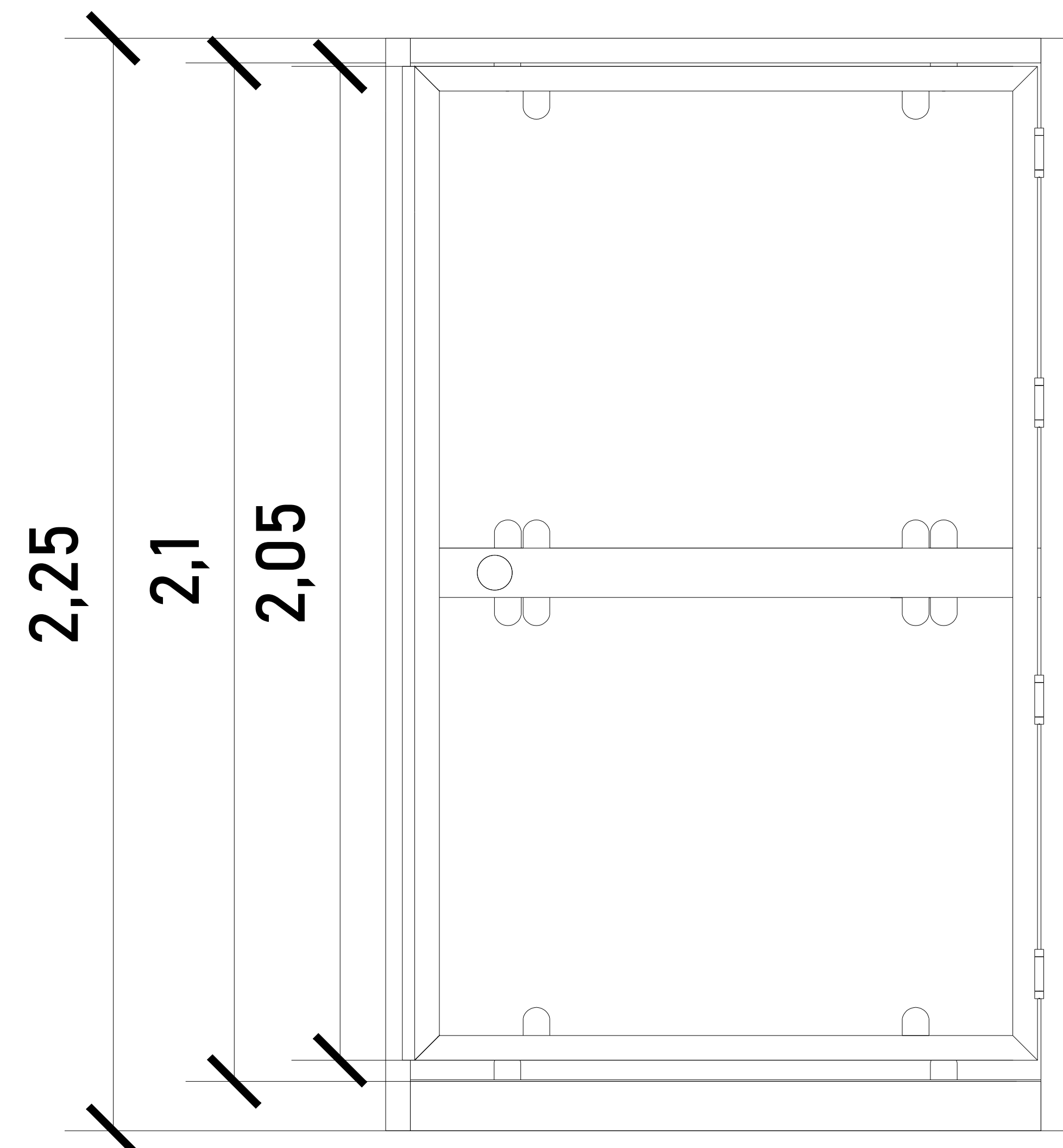

CABIN (FRONT VIEW)

EQUIPMENT HEIGHTS:

CAB HEIGHT	2.25 M
DOOR HEIGHT	2.05 M
INTERNAL HEIGHT CABIN	2.10 M

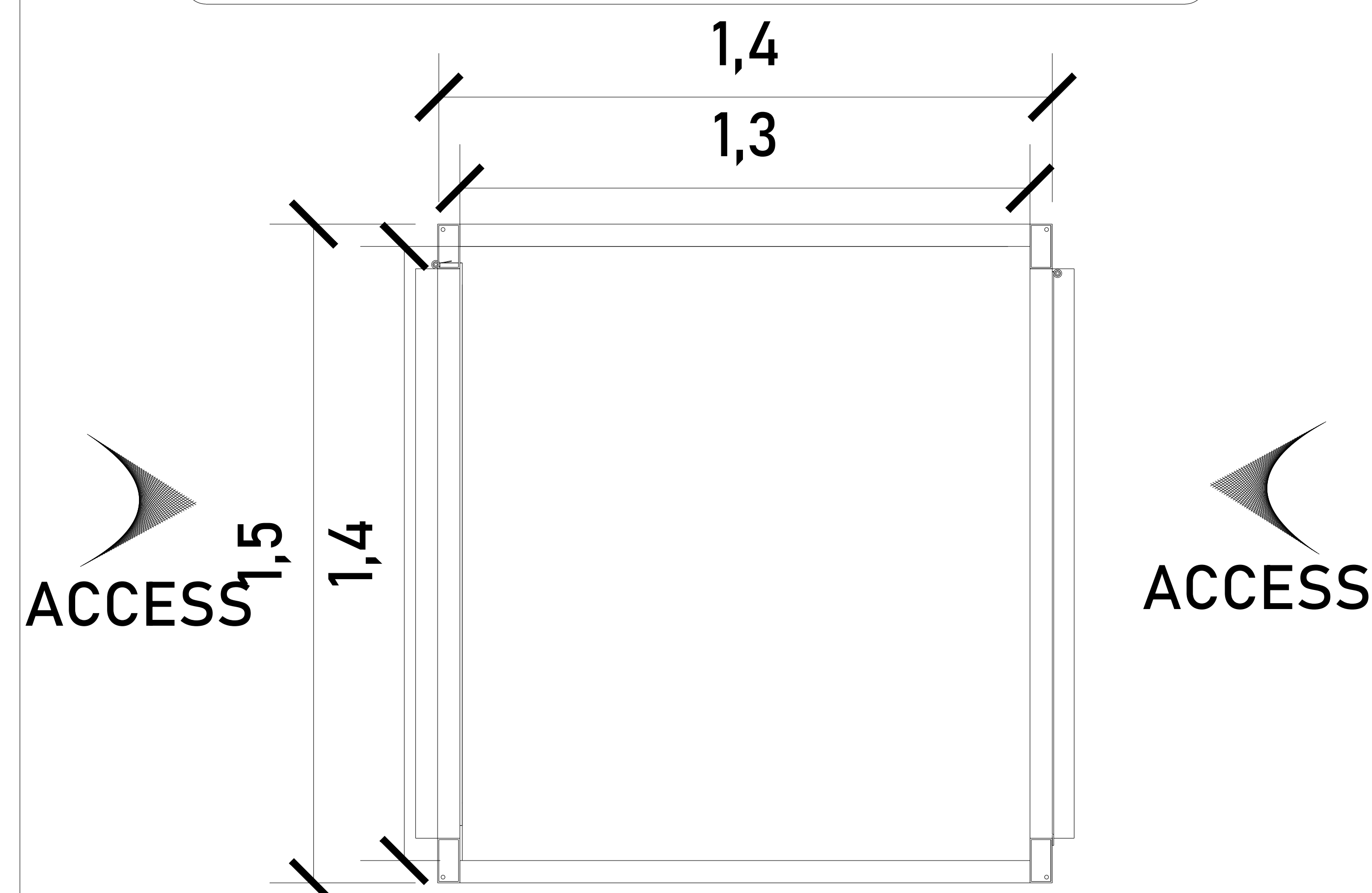

For access there is a 5cm flange, therefore it is requested that the elevator area be level and plumb at each of its stations . .

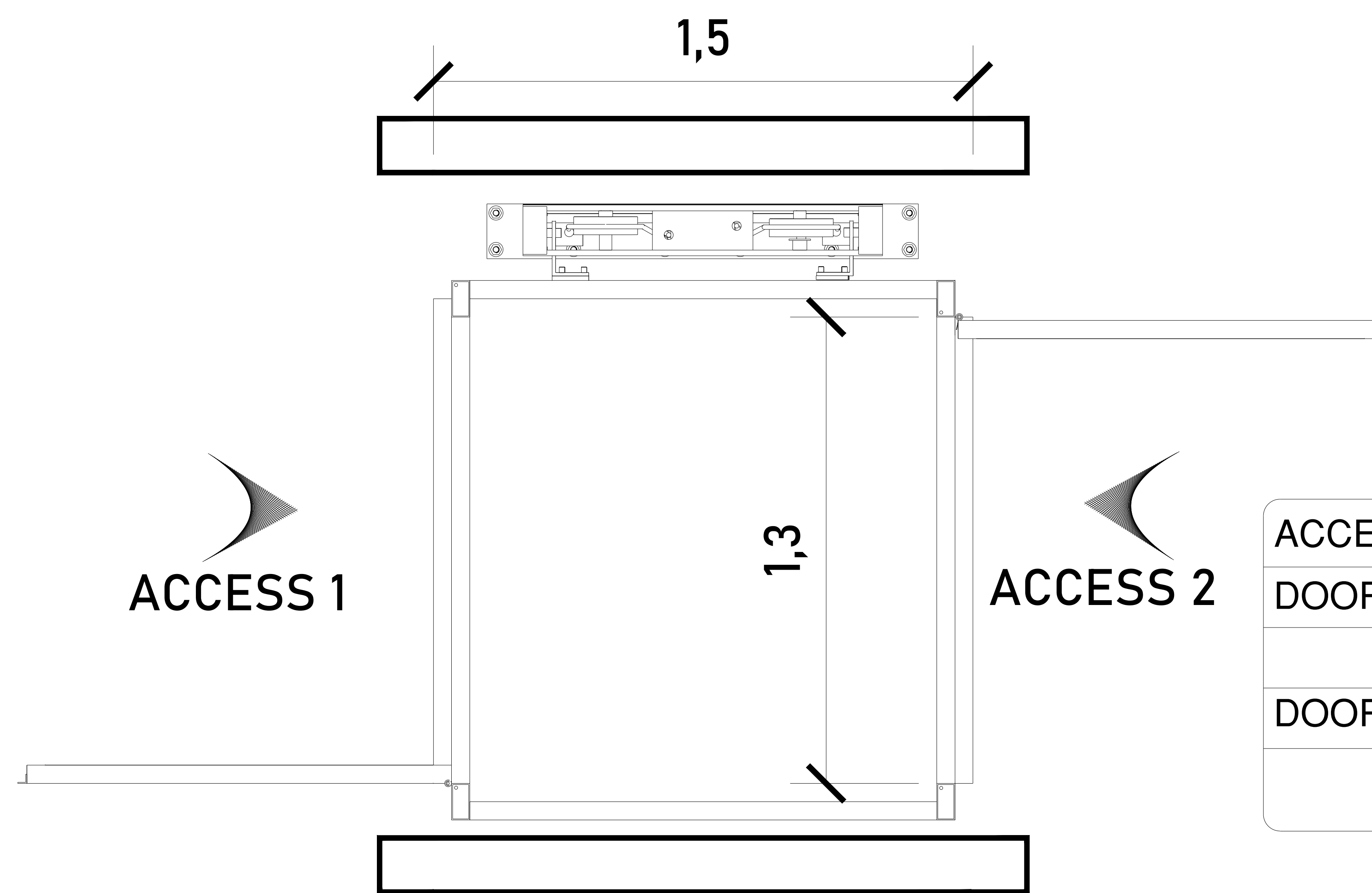

ACCESS AND DISCHARGE

ACCESS DIMENSIONS	
DOOR DIMENSION A1	1.30 M
DOOR DIMENSION A2	1.30 M

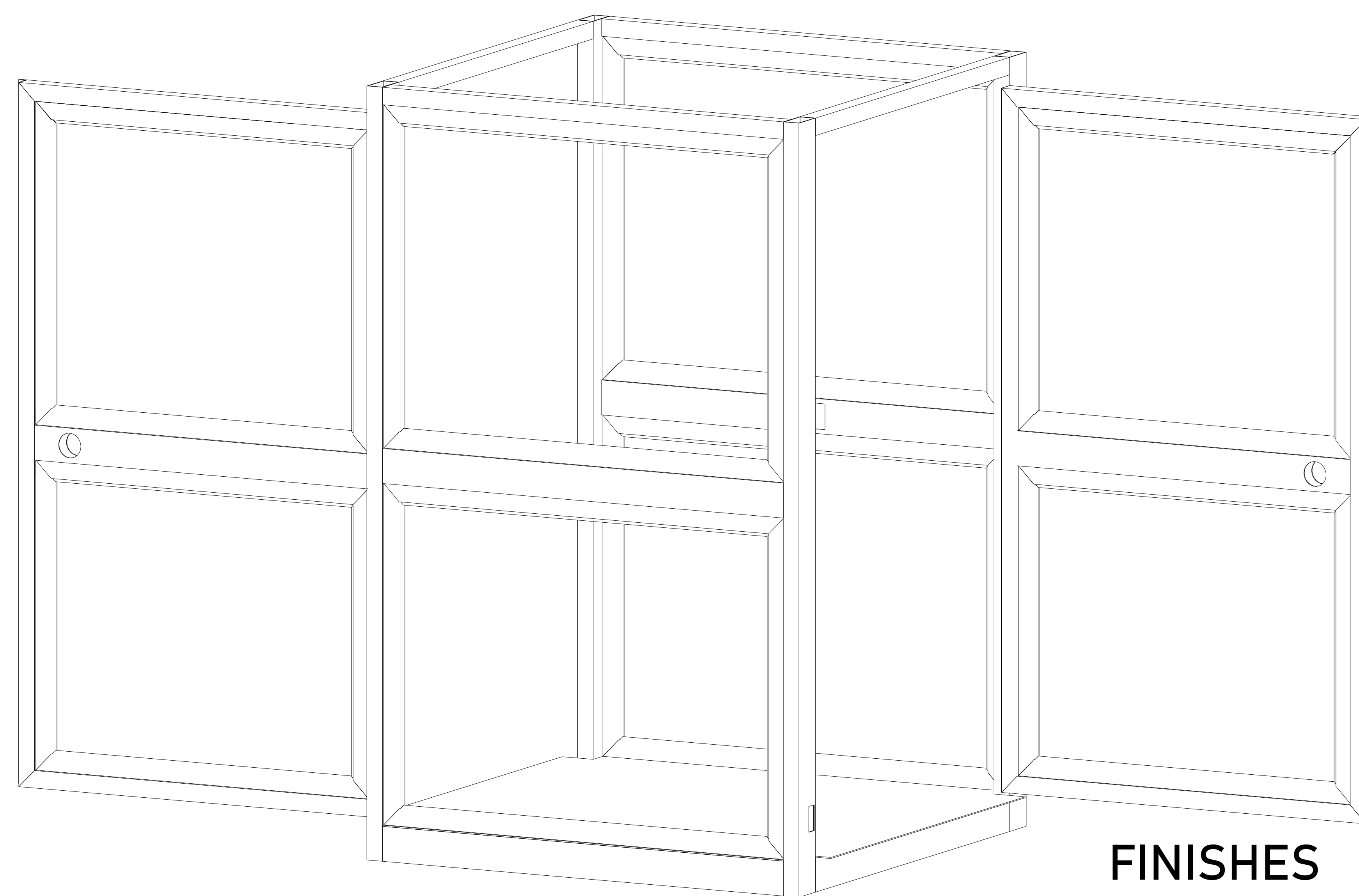

**FINISHES
EXPANDED METAL**

LOCALIZATION MAP:

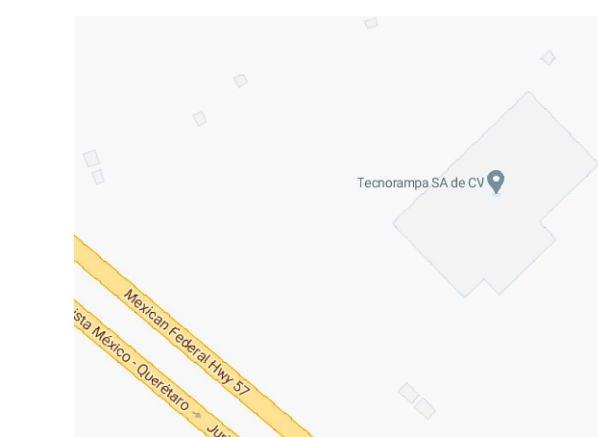

LOCATION:

Mexico-Querétaro Federal Highway

ORIENTATION:

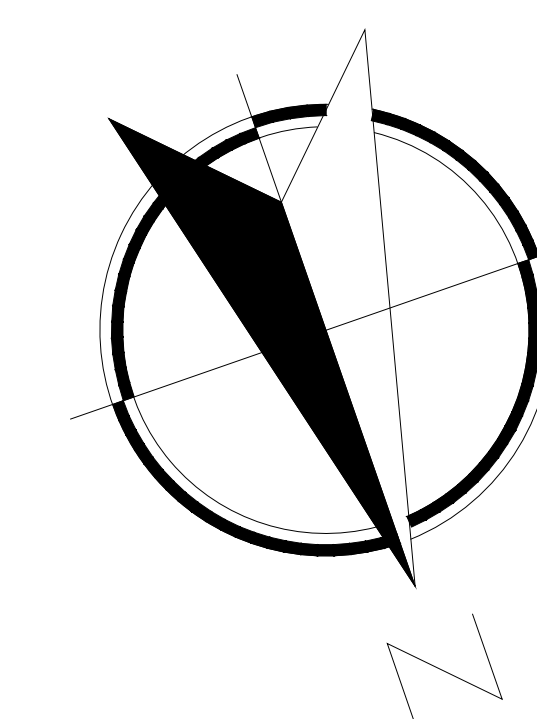

GENERAL NOTES

MODIFICATIONS TABLE:

NO.	DESCRIPTION	DATE

BUSINESS: **TecnoRampa**
SOLUCIONES DE TRANSPORTE Y SERVICIOS

BUSINESS NAME: **CUSTOMER NAME**

VOBO: _____ SELLER: _____
DATE: _____ ELEVATOR: _____

FLAT: **EQUIPMENT DIMENSIONS** KEY CODE: **A-3**

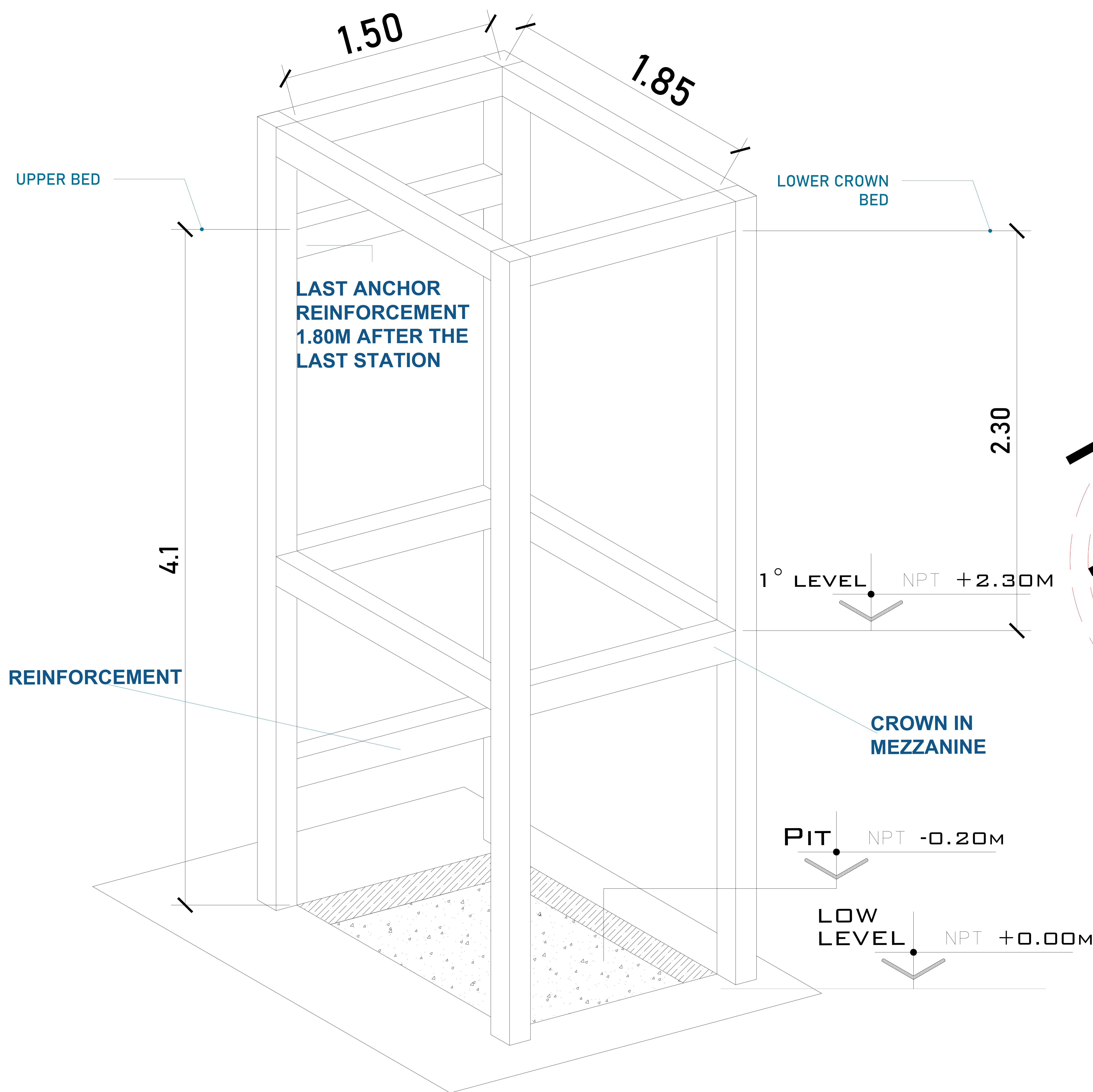

LAST ANCHOR REINFORCEMENT 1.80M AFTER THE LAST STATION

REINFORCEMENT

LOWER CROWN BED

CROWN IN MEZZANINE

1° LEVEL NPT +2.30M

PIT NPT -0.20M

LOW LEVEL NPT +0.00M

ESTRUCTURA
El Cliente suministra e instala

For the stability of the Tecnorampa team, it must be anchored to a certain number of reinforcements, these will be according to the team's route and the different levels that they have.

In the last station our columns have an overhang of 1.80m, therefore a reinforcement is requested at that height. The structure is not considered within the pit.

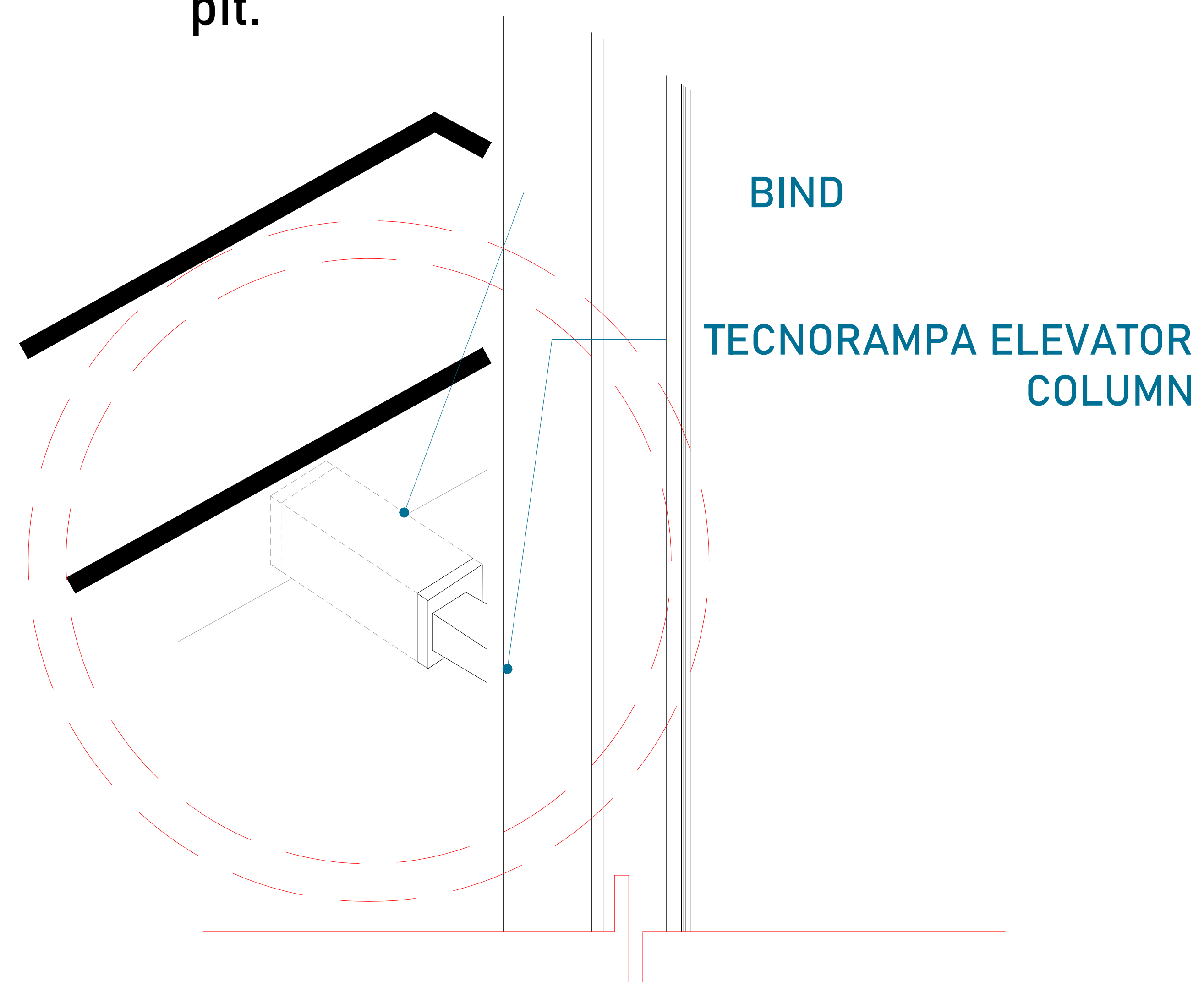

The columns of the Tecnorampa team are linked at different heights, which is why the reinforcements are requested, these are placed by the client.

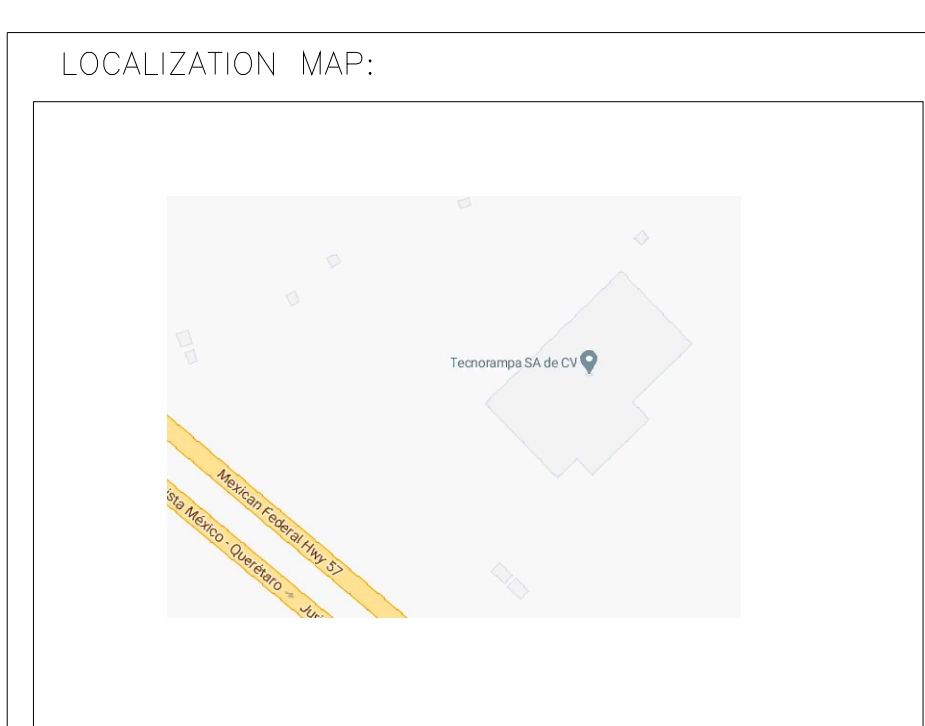

LOCATION:
Mexico-Querétaro Federal Highway

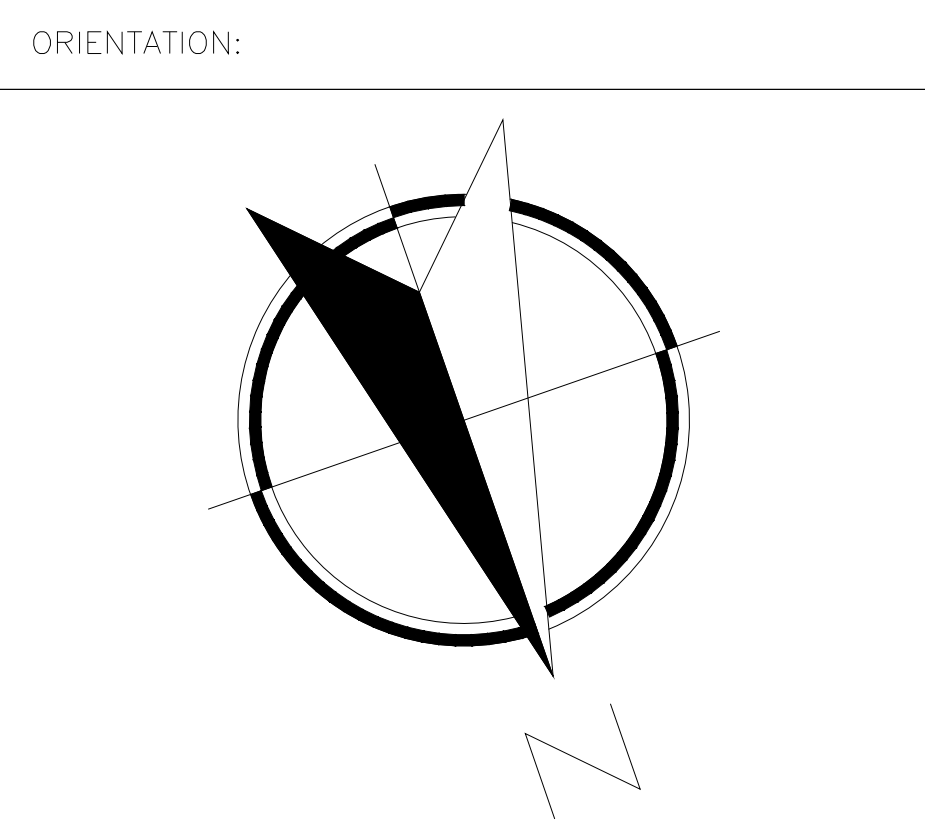

GENERAL NOTES

MODIFICATIONS TABLE:

NO.	DESCRIPTION	DATE

BUSINESS: **TecnoRampa**
ELEVADORES Y ESCALERAS

BUSINESS NAME: **CUSTOMER NAME**

VOBO: SELLER:

DATE: ELEVATOR:

FLAT: **ELEVATOR ANCHORAGE** KEY CODE: **A-4**

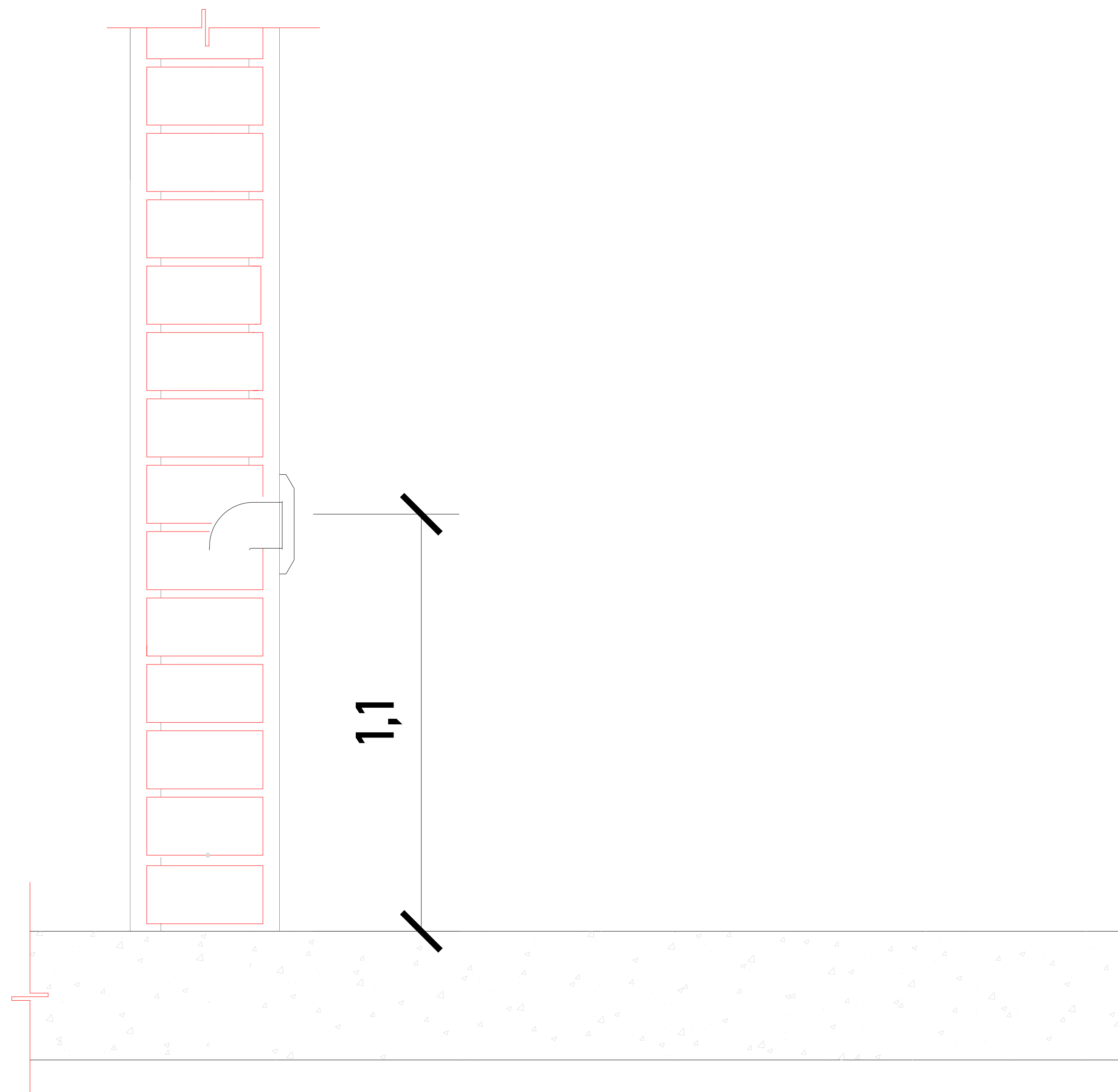

THE BUTTONS WILL BE OVERLAPPED

2HP HYDRAULIC UNIT DESCRIPTION	
ALIMENTATION	110 VCA
NUMBER OF PHASES	1
CONSUMPTION AMPERES	18.5
CONSUMPTION WATTS	1.5 KW
TYPE OF OIL	ISO 68

SIZE TABLE	
CALIBER	DISTANCE
8 AWG	0-10M
6 AWG	11-15 M
(CONTEMPLATE CALCULATION)	16- ONWARDS

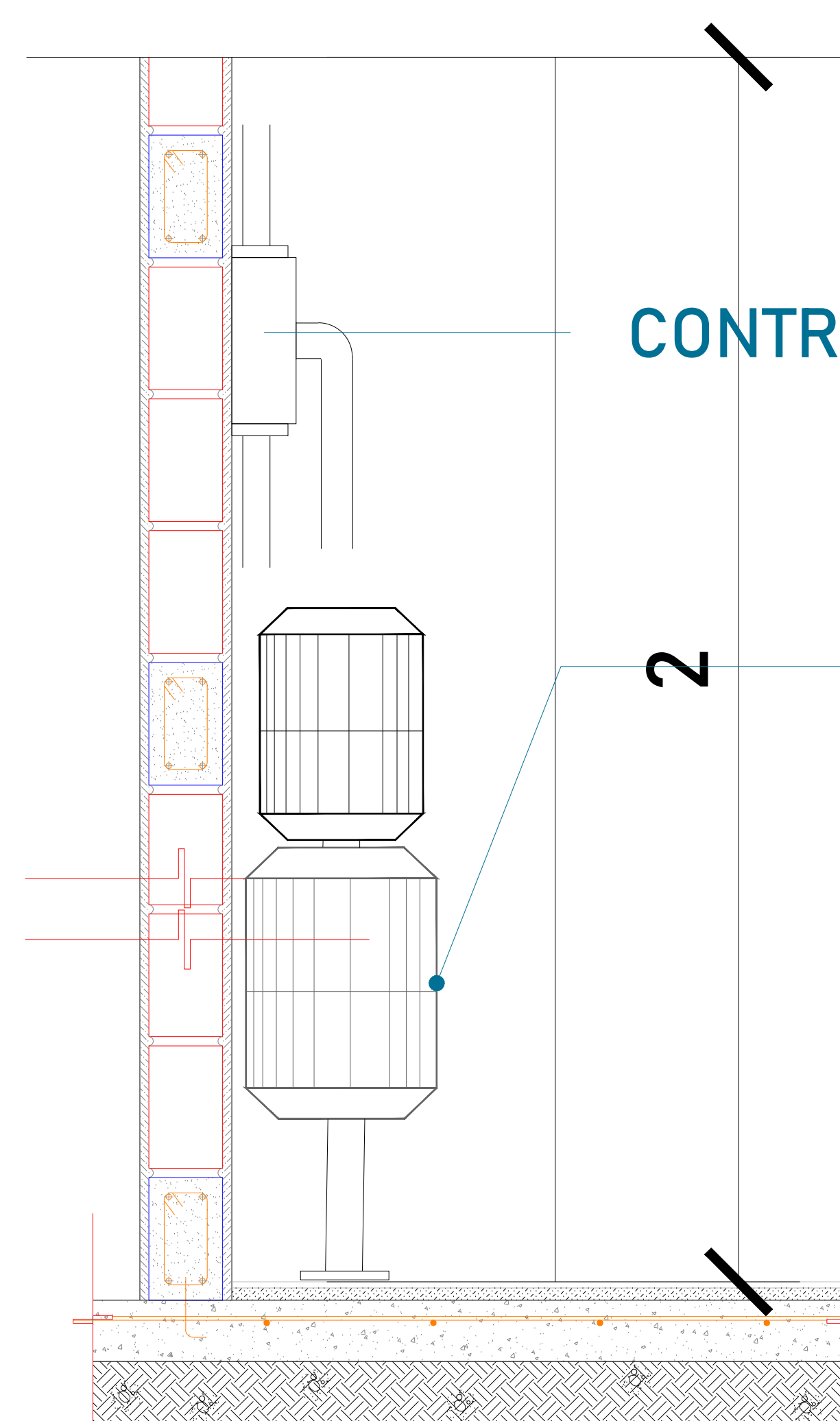

HYDRAULIC UNIT

The engine of the Tecnorampa equipment must be protected from dust and water or any substance that could contaminate the oil, therefore a niche of 1.00mx0.65mx2.00m is requested for its protection.

The client supplies, installs and energizes the load center with a 110V single-phase power supply, with neutral and physical ground, and a 1 x 30 Amp thermomagnetic switch exclusively for the elevator, as well as the channeling of pushbutton panels, which end in a register box, the above and the load center must be placed in the area where the hydraulic unit and electrical control provided by TECNORAMPA are located, no greater than 5.00m from the equipment area.

For security, it should not be manipulated by unauthorized personnel.

*By ignoring the indications already dictated and the equipment has a fault, Tecnorampa will not be responsible for these, in addition to the fact that the guarantee year would not have coverage for these damages.

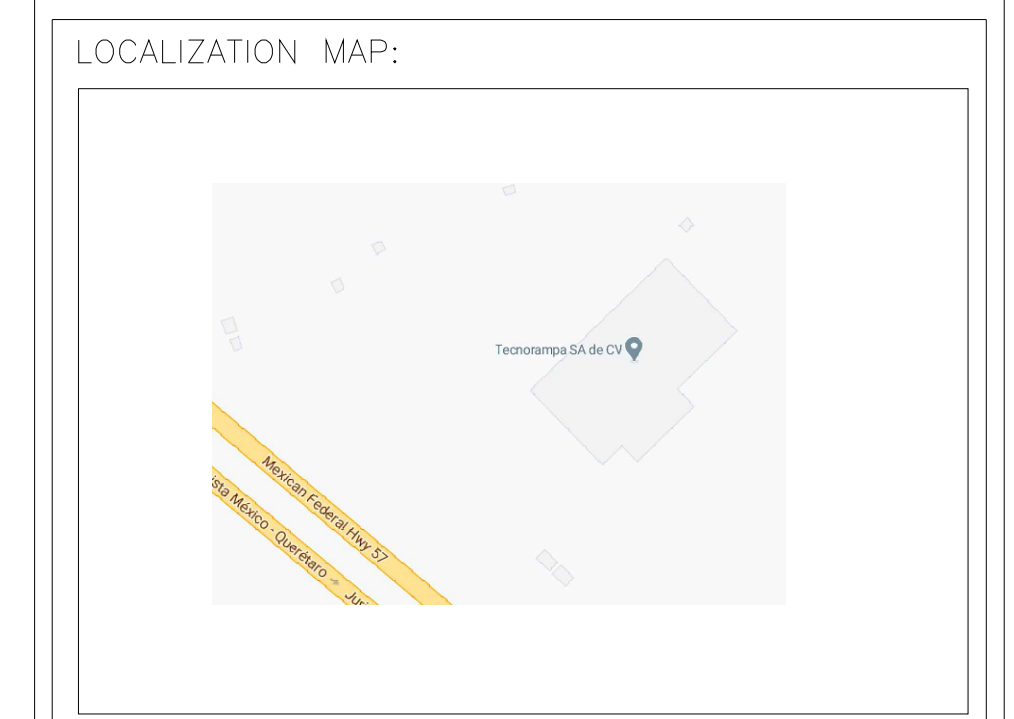

LOCATION
Mexico-Querétaro Federal Highway

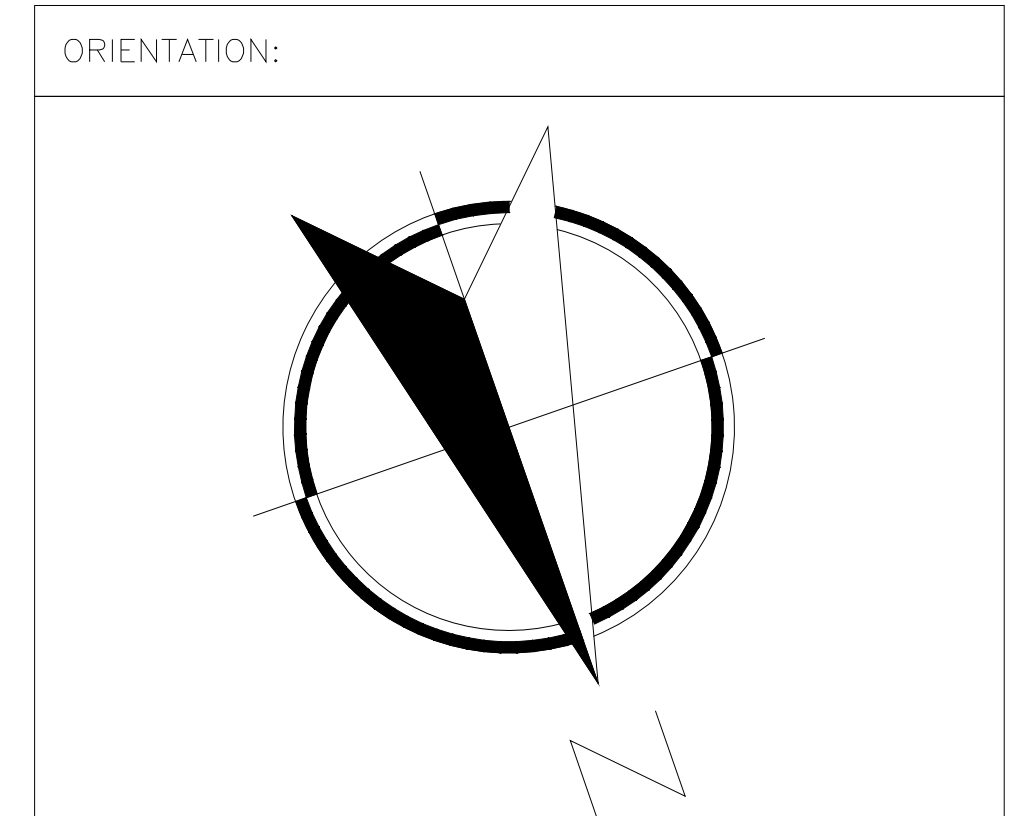

GENERAL NOTES

MODIFICATIONS TABLE:		
NO.	DESCRIPTION	DATE

BUSINESS: **TecnoRampa**
ELEVADORES Y EQUIPOS DE TRANSPORTE

BUSINESS NAME: **CUSTOMER NAME**

VOBO: _____ SELLER: _____
DATE: _____ ELEVATOR: _____

FLAT: **POWER SUPPLY AND BUTTONS** KEY CODE: **A-5**

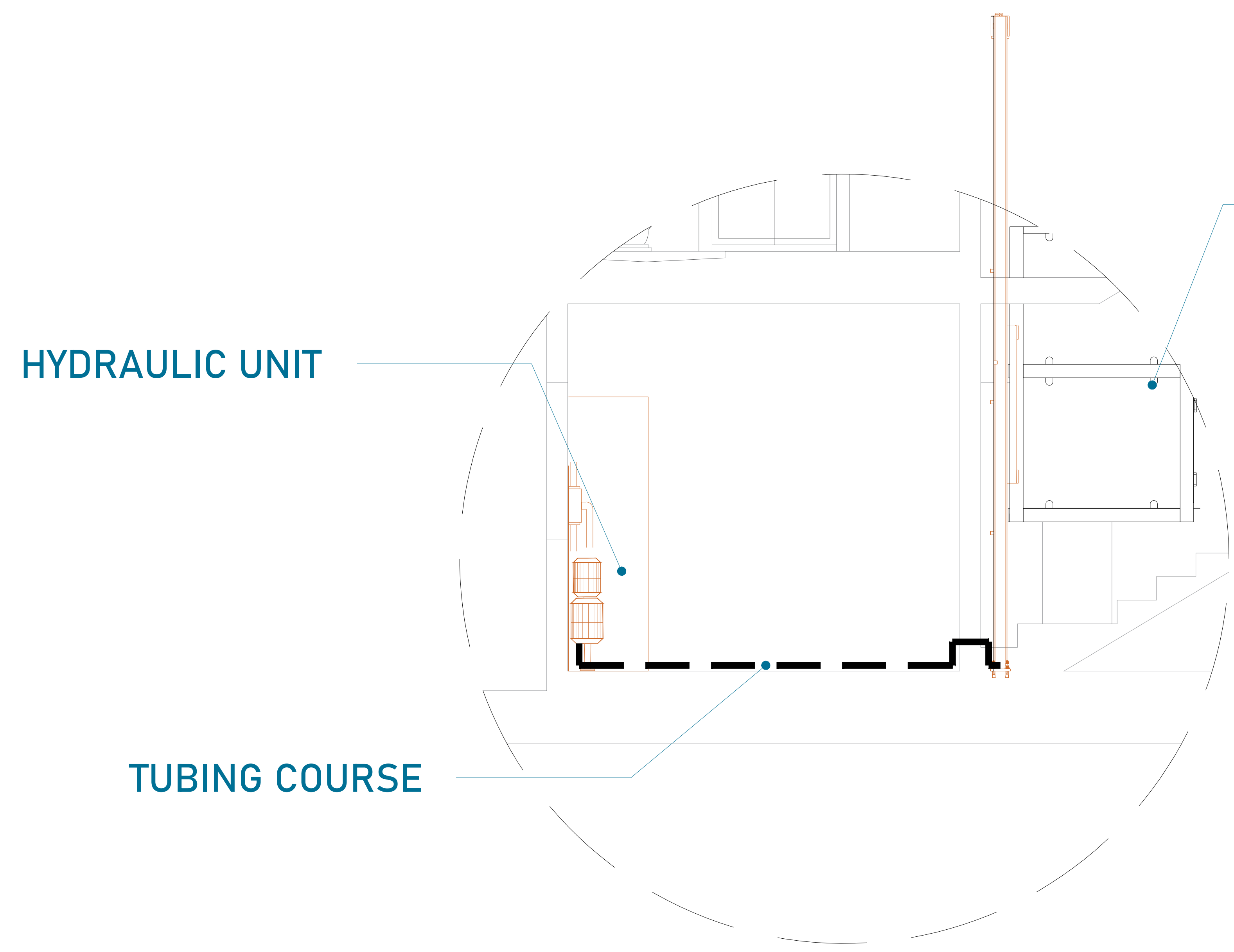

The tubing that is the connection of the elevator mechanism to the Hydraulic Unit, where the oil passes. It does not have to have a maximum distance of 5.00 linear meters.

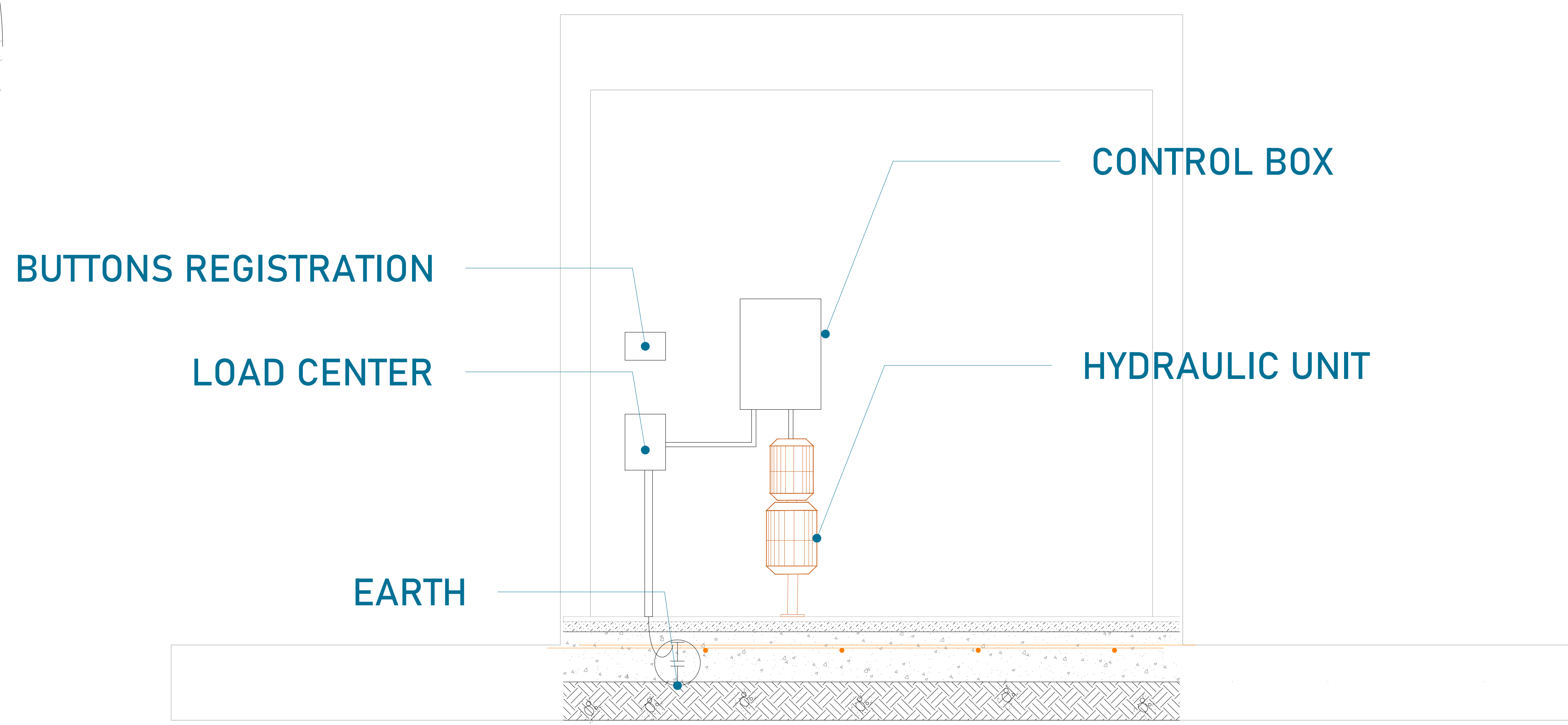

The image is illustrative only.

To power the equipment, a Hydraulic Unit is required. It is requested that this motor be as close as possible to the equipment, therefore the client is requested to have a 3" duct to be able to pass the tubing and the cables for the buttons there.

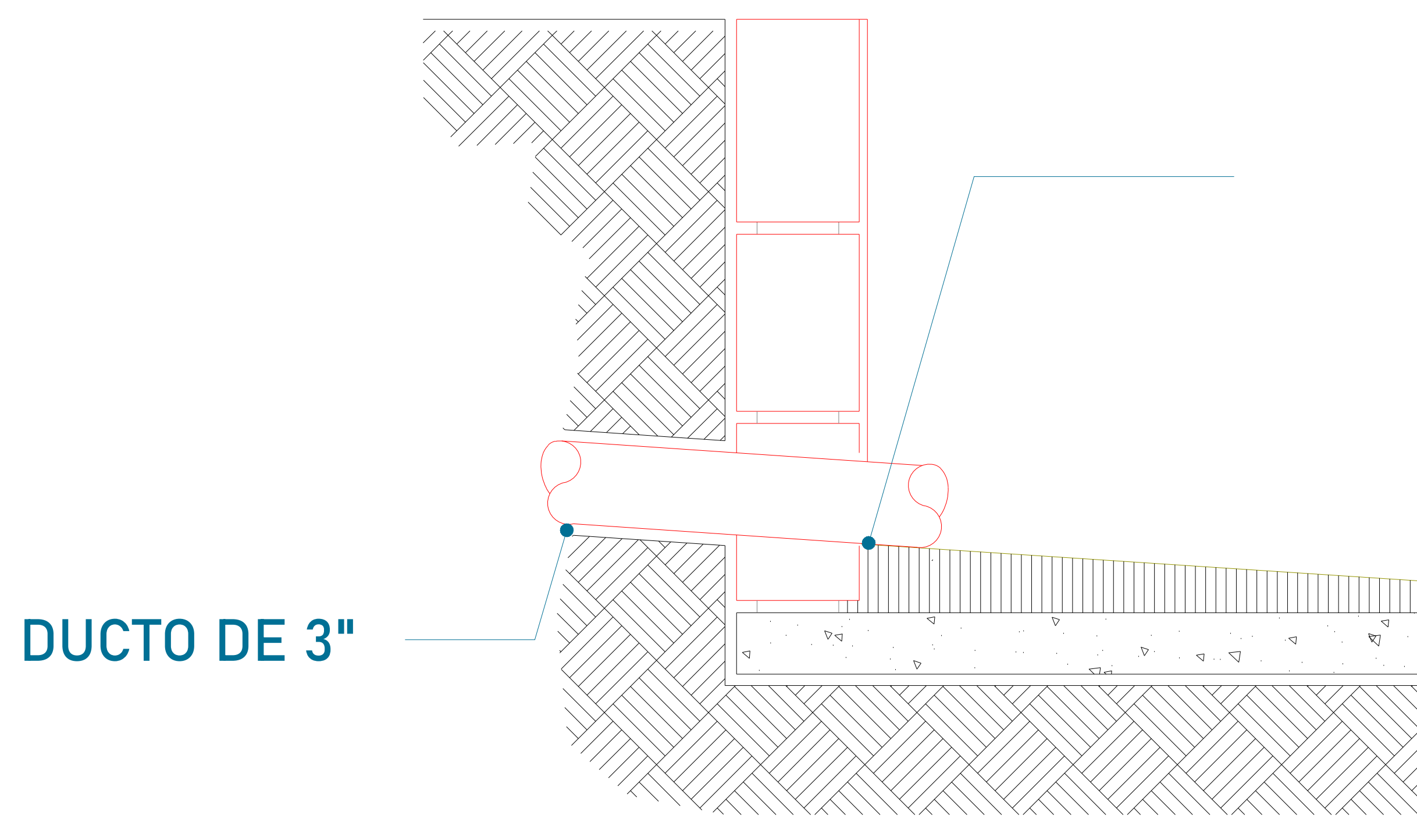

CONCRETE F'C=250 KG/CM²

ELECTRICAL WIRING PIPE TUBING

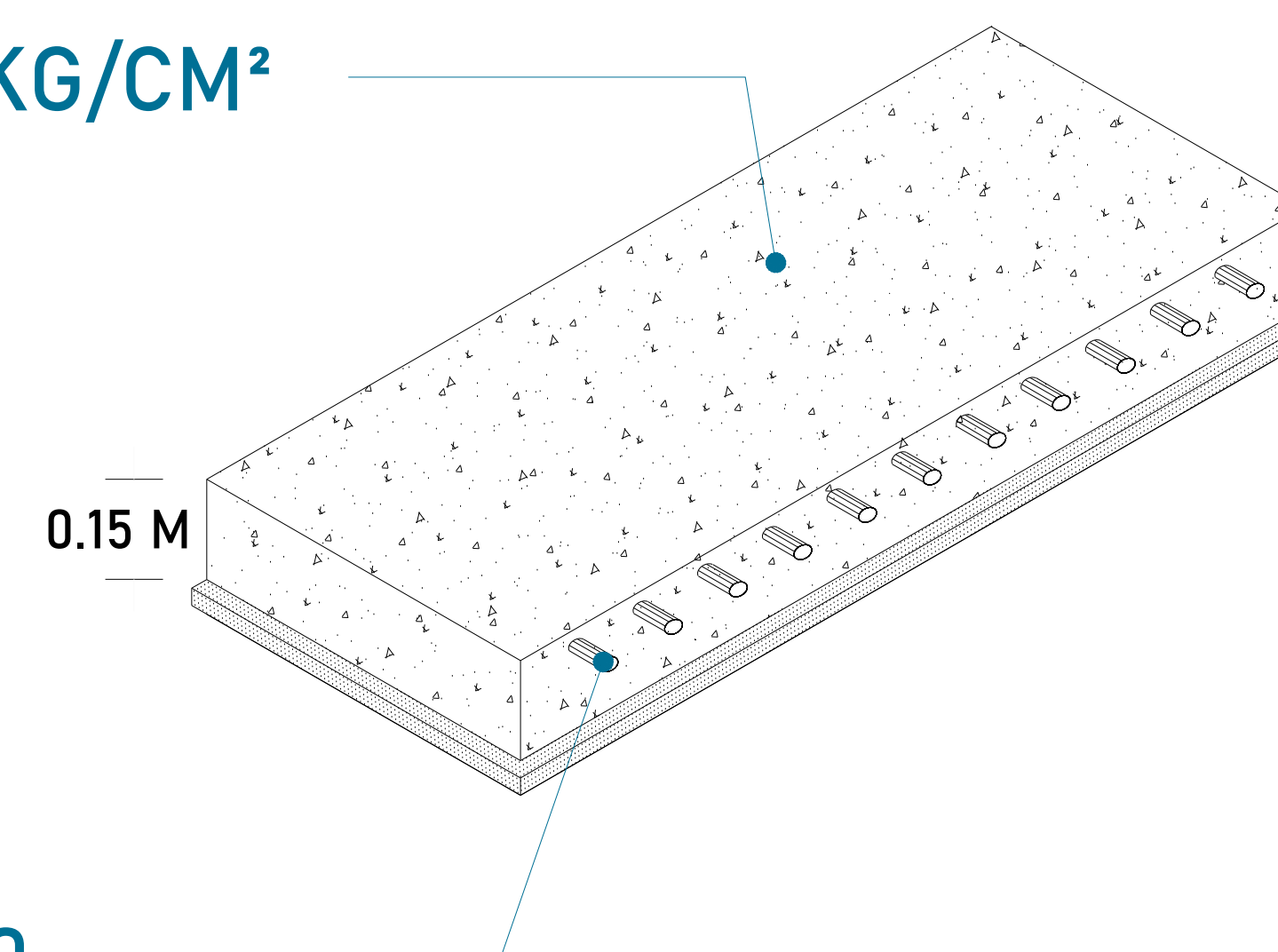

ELECTRO-WELDED MESH 6.6.10.10

The Hydraulic Unit is anchored, by means of 3/4" wide, 5" long harpoon-tip expansion anchors to the concrete surface where it rests.

LOCALIZATION MAP:

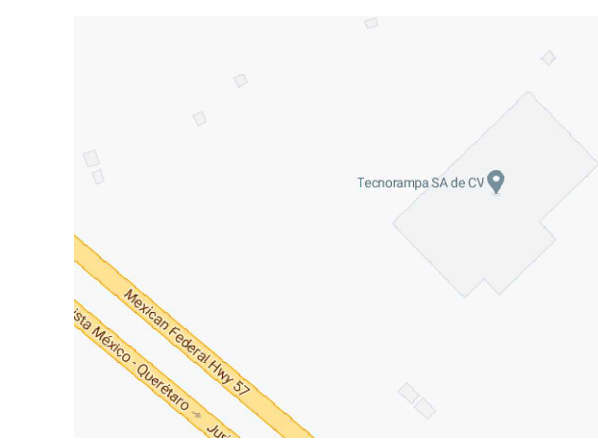

LOCATION
Mexico-Querétaro Federal Highway

ORIENTATION:

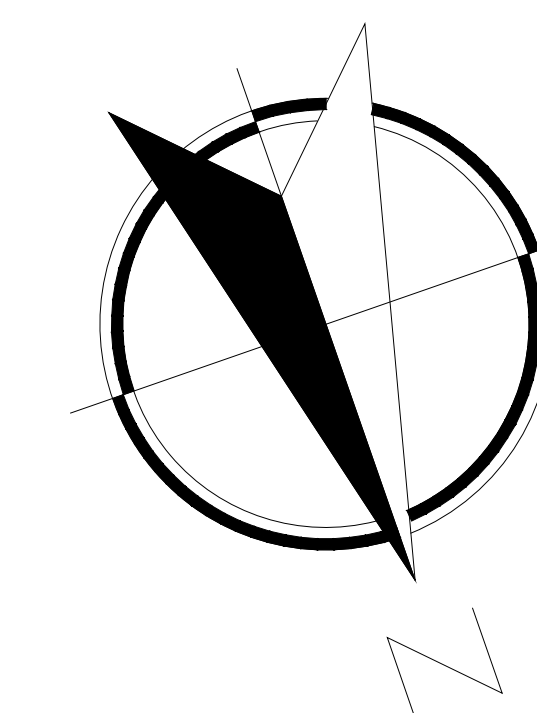

GENERAL NOTES

MODIFICATIONS TABLE:

NO.	DESCRIPTION	DATE

BUSINESS: **TecnoRampa**
INGENIERIA DE ELEVADORES Y ESCALERAS

BUSINESS NAME: **CUSTOMER NAME**

VOBO: _____ SELLER: _____
 DATE: _____ ELEVATOR: _____

FLAT: **DUCT AND HYDRAULIC UNIT** KEY CODE: **A-6**

OUTER DOOR

The elevator has a door that travels with it. Due to this situation, it is recommended to place a protection in each of the stations. Take into account that the dimensions of the elevator door must be respected.

PRECAUTIONS

Do not operate the lift when there is a hydraulic fluid leak.

Respect the indications without exceeding its weight capacity of 500kg.

Do not operate the equipment, without first having been delivered by an assigned staff of the Tecnorampa company.

Do not use the elevator in case of fire.

Do not operate the lift if the steel cables are frayed.

INSTALLATION REQUIREMENTS

- 1.- The pit will be in optimal conditions
 - a) No waterlogging
 - b) No objects or materials inside
 - c) Free access to the installation area
 - 2.- 220V power is needed to connect a welding machine to 2 phases, consumption capacity of 60 Amp
- *In case of not having the power supply, contact your vendor for a solution.
- 3.- The civil work (pit and reinforcements) must be ready on the scheduled date of its installation.
 - 4.- Consider the access space and openings on site for the access of the equipment to the place of its installation

LOCALIZATION MAP:

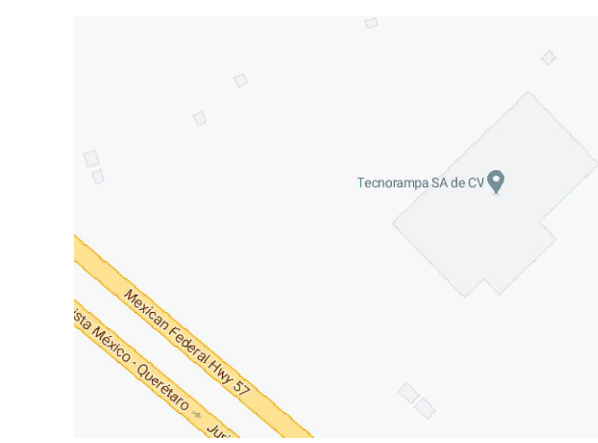

LOCATION

Mexico-Querétaro Federal Highway

ORIENTATION:

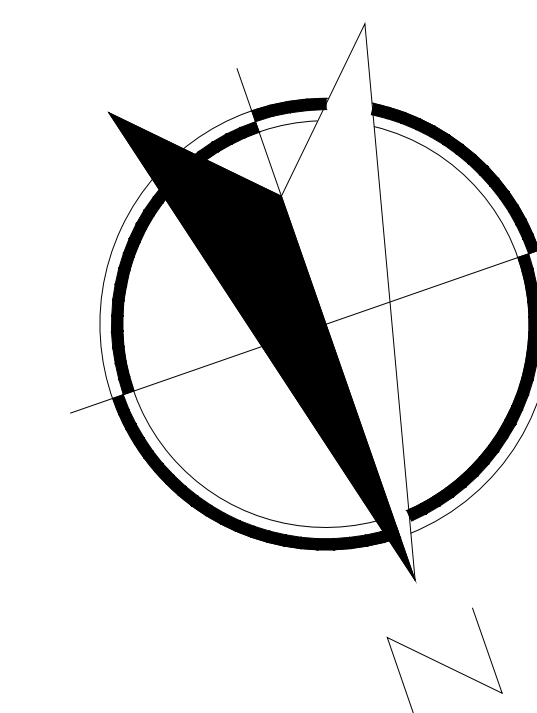

GENERAL NOTES

MODIFICATIONS TABLE:

NO.	DESCRIPTION	DATE

BUSINESS: **TecnoRampa**
SOLUCIONES DE TRANSPORTE Y SERVICIOS

BUSINESS NAME: **CUSTOMER NAME**

VOBO: SELLER:
DATE: ELEVATOR:

FLAT: **ACCESSORIES** KEY CODE: **A-7**